



Reddings Close

£1,495,000

2552 sq ft - Located opposite St Josephs open space with stunning views. An immaculate one of a kind, fully modernised, turn key 6 bedroom property finished to the highest standard with modern features throughout.

The ground floor comprises of a stunning open plan living area, with a reception room, dining area, modern fully equipped kitchen, separate utility area and a separate reception room in addition to under floor heating throughout, smart home features with bi-folding doors to a covered patio area, outdoor kitchen and w/c.

On the first floor there are 4 spacious bedrooms and 2 bathrooms (1 en-suite) the top floor consist of a master bedroom with en-suite walk in wardrobe in addition to a dressing room/gym.

This property is truly finished to the highest standard with no expense spared, with further benefits including, electric car charge points, walking distance to mill hill Broadway and off-street parking. Sole Agent. Chain Free.

Viewing

Please contact our Mill Hill Office on 020 8959 0011 if you wish to arrange a viewing appointment for this property or require further information.



Floor Plan

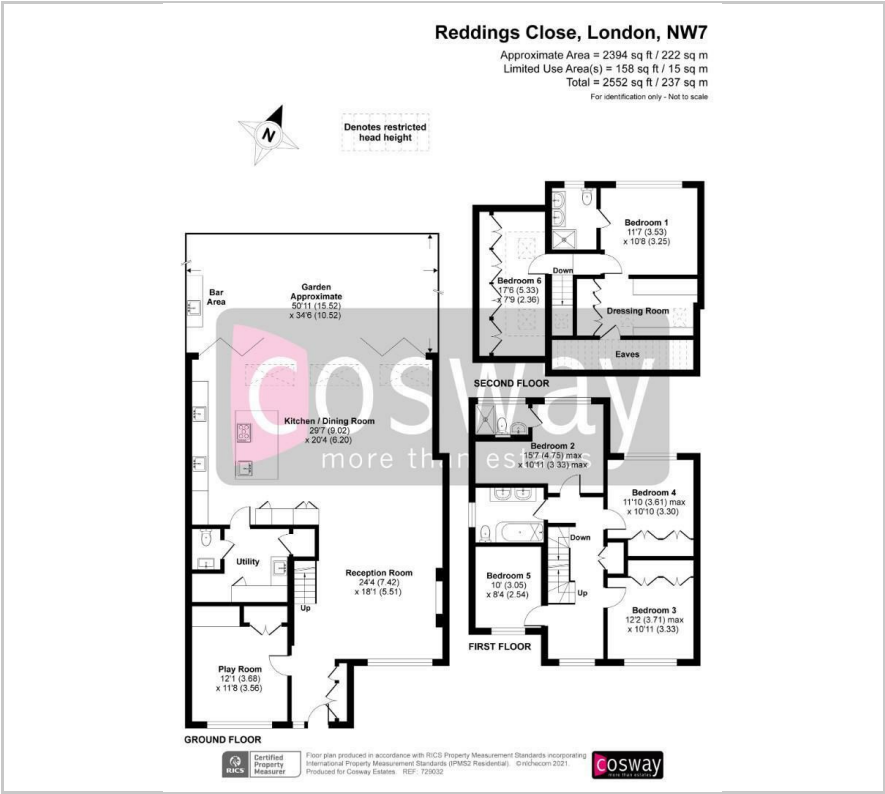

Area Map



Energy Efficiency Graph

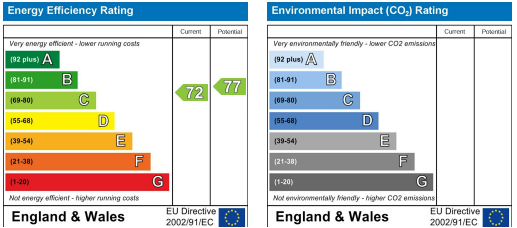

These particulars, whilst believed to be accurate are set out as a general outline only for guidance and do not constitute any part of an offer or contract. Intending purchasers should not rely on them as statements of representation of fact, but must satisfy themselves by inspection or otherwise as to their accuracy. No person in this firms employment has the authority to make or give any representation or warranty in respect of the property.